

H. C. P. 33. 45 NW 1st Parks

300 Acres

Plan of Brantley Town

6th Street

5th Street

N 55. W 157 Parks

N 35 E 12 Parks

N 5

E 109 Parks

N 35 E 11 Parks

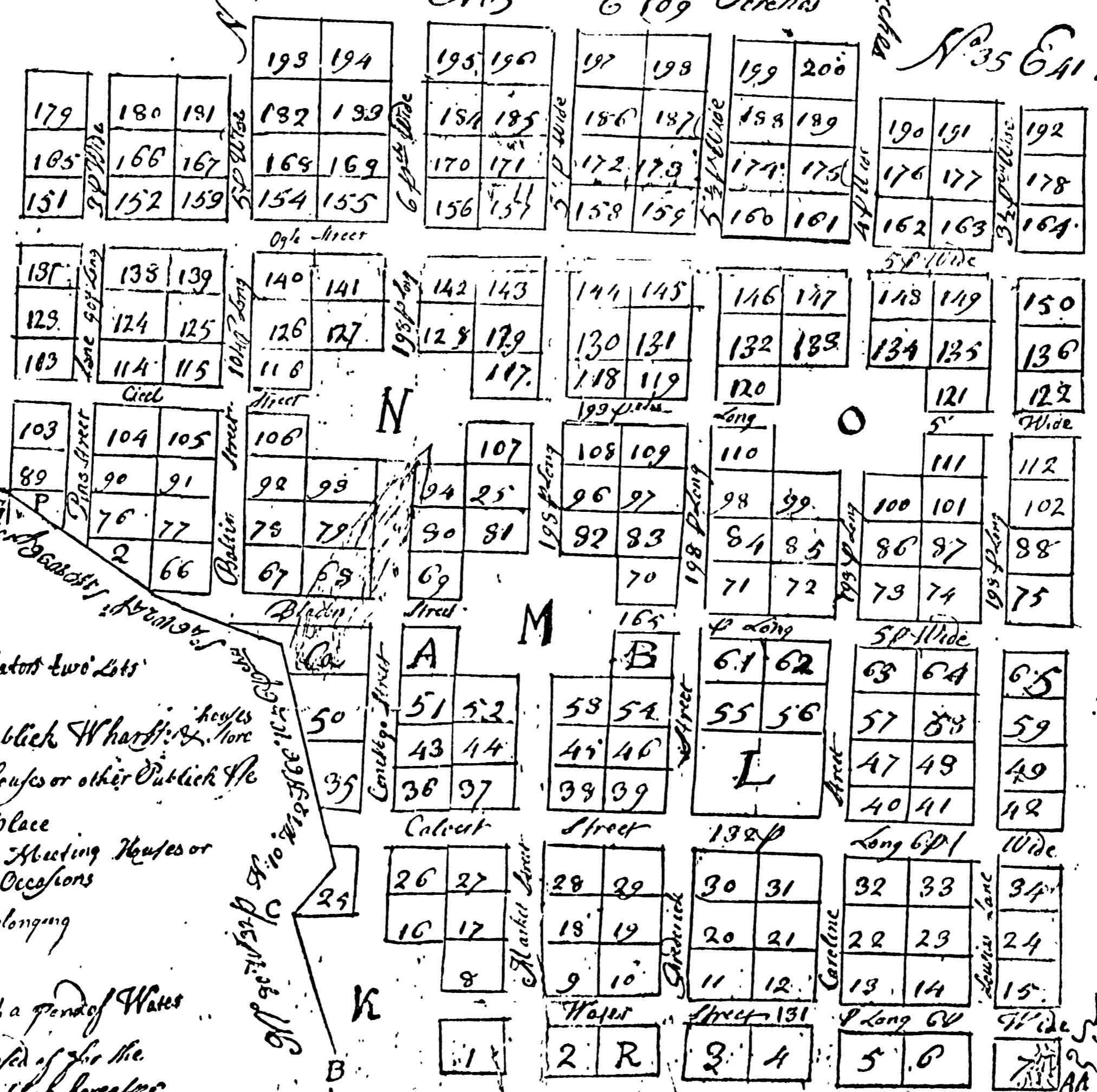

- A? The Lord Proprietors two Lots
- B? Vacancies for Public Wharves
- L? for Court houses or other Public Use
- M For Market place
- N? Two Squares for Meeting Houses or other Public Occasions
- O? Vacancies also belonging to the Public
- R? Land covered with a pond of Water May be disposed of for the Use of the Public hereafter

North East River

Public Wharf

Appl. Oct